

MB Nylon Frame Plug for softer materials



Features

- ETAG 020 - Approved for multiple use in concrete and masonry for non-structural applications
- Fire resistance test certification F90 for fastening of façade systems
- Approved and suitable for applications in perforated brick, masonry and aerated concrete
- Aerated Concrete: Drill-Ø 9mm, setting depth 90mm
- MB with extended expansion zone for optimum applications in low density materials and hollow brick
- Knock-in protection prevents premature expansion while installing
- Wings stop the plug rotating in the drill hole
- Oversize plugs moulded in one-piece up to the overall length of 300mm
- Plug made from high-quality polyamide PA6
- Through fixing
- Indoor (zinc plated) and outdoor (stainless steel) applications

Applications

façade fixings, profiles, substructures, frames

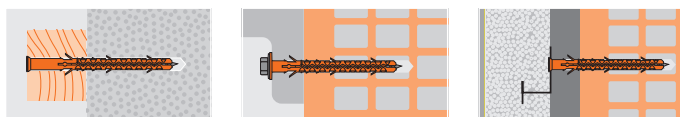

Technical Data

	Perforated Brick app. load (kN)	Lightweight Concrete app. load (kN)	Aerated Concrete app. load (kN)	Bending moment (Nm) galv. steel	Bending moment (Nm) stainl. steel
MB 8	1) 0.3	1) 0.4	1) 0.3	1) 3.4	1) 3.2
MB 10	0.3	0.5	1) 0.3	1) 11.1	1) 10.4

Important: Recommended loads / The approved loads and detailed specifications of stones can be found in the approval ETA-15/0068 / Approved loads: Tension, shear and combined loads / without hammer drilling in perforated brick and lightweight concrete / 1 kN ≈ 100 kg / Safety factor of 2.5 is included / Values only valid when using Mungo safety screws / 1) Mungo lab tested

Installation



Article code	Plug and drill ∅ mm d _{nom} = d ₀	Length mm	Usable length mm	Screw ∅ mm	Screw length mm	Drive	Box content	Outer carton	Quantity per pallet
		L	t _{fix}	d _s	L _s		FS	SK	
1) 1122100	8	80	10	6	85	T30	100 51	600 32	14400
1) 1122101	8	100	30	6	105	T30	100 51	600 32	14400
1) 1122102	8	120	50	6	125	T30	100 51	600 32	14400
1) 1122104	8	140	70	6	145	T30	100 51	600 32	14400
1122108	10	80	10	7	85	T40	100 51	600 32	14400
1122110	10	100	30	7	105	T40	50 51	300 32	7200
1122112	10	120	50	7	125	T40	50 51	300 32	7200
1122114	10	140	70	7	145	T40	50 51	300 32	7200
1122116	10	160	90	7	165	T40	50 51	300 32	7200
1122120	10	200	130	7	205	T40	50 51	300 32	7200
1122124	10	240	170	7	245	T40	25 61	50 12	3000
1122128	10	280	210	7	285	T40	25	-	-
1122130	10	300	230	7	305	T40	25	-	-

1) Not part of the approval

MB-ST Nylon Frame Plug with screw T30/T40



Article code	Plug and drill ∅ mm d _{nom} = d ₀	Length mm	Usable length mm	Screw ∅ mm	Screw length mm	Wrench size	Box content	Outer carton	Quantity per pallet
		L	t _{fix}	d _s	L _s	SW	FS	SK	
1121908	10	80	10	7	85	13	100 51	600 32	14400
1121910	10	100	30	7	105	13	50 51	300 32	7200
1121912	10	120	50	7	125	13	50 51	300 32	7200
1121914	10	140	70	7	145	13	50 51	300 32	7200
1121916	10	160	90	7	165	13	50 51	300 32	7200
1121920	10	200	130	7	205	13	50 51	300 32	7200
1121924	10	240	170	7	245	13	25 61	50 12	3000
1121928	10	280	210	7	285	13	25	-	-
1121930	10	300	230	7	305	13	25	-	-

MB-SS Nylon Frame Plug with hexagon screw



Article code	Plug and drill ∅ mm d _{nom} = d ₀	Length mm	Usable length mm	Screw ∅ mm	Screw length mm	Drive	Box content	Outer carton	Quantity per pallet
		L	t _{fix}	d _s	L _s		FS	SK	
1) 1122300	8	80	10	6	85	PZ3	100 51	600 32	14400
1) 1122301	8	100	30	6	105	PZ3	100 51	600 32	14400
1) 1122302	8	120	50	6	125	PZ3	100 51	600 32	14400
1) 1122304	8	140	70	6	145	PZ3	100 51	600 32	14400
1122308	10	80	10	7	85	PZ3	100 51	600 32	14400
1122310	10	100	30	7	105	PZ3	50 51	300 32	7200
1122312	10	120	50	7	125	PZ3	50 51	300 32	7200
1122314	10	140	70	7	145	PZ3	50 51	300 32	7200
1122316	10	160	90	7	165	PZ3	50 51	300 32	7200
1122320	10	200	130	7	205	PZ3	50 51	300 32	7200

1) Not part of the approval

MB-S Nylon Frame Plug with screw Pozi 3



Article code	Plug and drill ∅ mm d _{nom} = d ₀	Length mm	Usable length mm	Screw ∅ mm	Screw length mm	Wrench size	Box content	Outer carton	Quantity per pallet
		L	t _{fix}	d _s	L _s	SW	FS	SK	
1120608	10	80	10	7	85	13	50 61	450 32	10800
1120610	10	100	30	7	105	13	50 61	300 32	7200
1120612	10	120	50	7	125	13	50 61	300 32	7200

MBK-STB Nylon Frame Plug with collar and hexagon screw, T40, collar



Article code	Plug and drill ∅ mm d _{nom} = d ₀	Length mm	Usable length mm	Screw ∅ mm	Screw length mm	Drive	Box content	Outer carton	Quantity per pallet
		L	t _{fix}	d _s	L _s		FS	SK	
1) 1136908	8	80	10	6	85	T30	100 51	600 32	14400
1) 1136910	8	100	30	6	105	T30	100 51	600 32	14400
1) 1136912	8	120	50	6	125	T30	100 51	600 32	14400
1) 1136914	8	140	70	6	145	T30	100 51	600 32	14400
1137208	10	80	10	7	85	T40	100 51	600 32	14400
1137210	10	100	30	7	105	T40	50 51	300 32	7200
1137212	10	120	50	7	125	T40	50 51	300 32	7200
1137214	10	140	70	7	145	T40	50 51	300 32	7200
1137216	10	160	90	7	165	T40	50 51	300 32	7200
1137220	10	200	130	7	205	T40	50 51	300 32	7200
1137224	10	240	170	7	245	T40	25 61	50 12	3000
1137228	10	280	210	7	285	T40	25	-	-
1137230	10	300	230	7	305	T40	25	-	-

1) Not part of the approval

MB-STr Nylon Frame Plug with screw T30/T40, stainless steel A4/316



Article code	Plug and drill ∅ mm d _{nom} = d ₀	Length mm	Usable length mm	Screw ∅ mm	Screw length mm	Wrench size	Box content	Outer carton	Quantity per pallet
		L	t _{fix}	d _s	L _s	SW	FS	SK	
1135208	10	80	10	7	85	13	100 51	600 32	14400
1135210	10	100	30	7	105	13	50 51	300 32	7200
1135212	10	120	50	7	125	13	50 51	300 32	7200
1135214	10	140	70	7	145	13	50 51	300 32	7200
1135216	10	160	90	7	165	13	50 51	300 32	7200
1135220	10	200	130	7	205	13	50 51	300 32	7200
1135224	10	240	170	7	245	13	25 61	50 12	3000
1135228	10	280	210	7	285	13	25	-	-
1135230	10	300	230	7	305	13	25	-	-

MB-SSr Nylon Frame Plug with hexagon screw, stainless steel A4/316



MBK-STBr Nylon Frame Plug with collar and hexagon screw, T40, collar, stainless steel A4/316



Article code	Plug and drill \varnothing mm $d_{nom} = d_0$	Length mm L	Usable length mm t_{fix}	Screw \varnothing mm d	Screw length mm L	Wrench size SW	Box content FS	Outer carton SK	Quantity per pallet
1136208	10	80	10	7	85	13	50 ⁴¹	450 ³²	10800
1136210	10	100	30	7	105	13	50 ⁵¹	300 ³²	7200



MB-SK Nylon Frame Plug with head hole

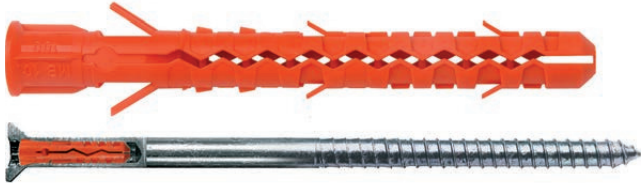

Applications

thermal insulation on façades, lamps, roller blinds, rails, wardrobes, letter boxes

Technical Data

	Perforated Brick tension load (kN)	Lightweight Concrete tension load (kN)	Aerated Concrete tension load (kN)	Head hole tension load (kN) screw \varnothing 4mm	Head hole shear load (kN) screw: steel quality 4.6
MB-SK 10	0.25	0.25	0.25	0.1	-
MB-SKm 10	0.25	0.25	0.25	-	1.68

without hammer drilling in perforated brick and lightweight concrete / Safety factor (ground) of 5 is included / Safety factor (head hole) of 2 is included / Shear load: without consideration of edge and anchor distances / 1 kN \approx 100 kg

Installation

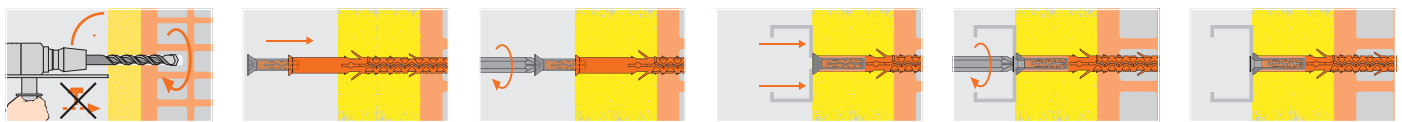

MB-SK Nylon Frame Plug incl. screw with head hole/MN5/T40



Article code	Plug and drill \varnothing mm $d_{nom} = d_0$	Length mm L	Usable length mm t_{fix}	Drive	Box content FS	Outer carton SK	Quantity per pallet
1121808	10	80	10	T40	100 ⁵¹	600 ³²	14400
1121810	10	100	30	T40	50 ⁵¹	300 ³²	7200
1121812	10	120	50	T40	50 ⁵¹	300 ³²	7200
1121814	10	140	70	T40	50 ⁵¹	300 ³²	7200
1121816	10	160	90	T40	50 ⁵¹	300 ³²	7200
1121820	10	200	130	T40	50 ⁵¹	300 ³²	7200
1121824	10	240	170	T40	25 ⁵¹	50 ³²	3000
1121828	10	280	210	T40	25	-	-
1121830	10	300	230	T40	25	-	-



MB-SKm Nylon Frame Plug incl. screw with head hole/M5/T40



Article code	Plug and drill \varnothing mm $d_{nom} = d_0$	Length mm L	Usable length mm t_{fix}	Drive	Internal thread d	Internal thread length mm L_{in}	Box content FS	Outer carton SK	Quantity per pallet
1123010	10	100	30	T40	M5	18	50 ⁵¹	300 ³²	7200
1123012	10	120	50	T40	M5	18	50 ⁵¹	300 ³²	7200
1123014	10	140	70	T40	M5	18	50 ⁵¹	300 ³²	7200
1123016	10	160	90	T40	M5	18	50 ⁵¹	300 ³²	7200
1123020	10	200	130	T40	M5	18	50 ⁵¹	300 ³²	7200

