

PASLODE LITELINE  
90F50B

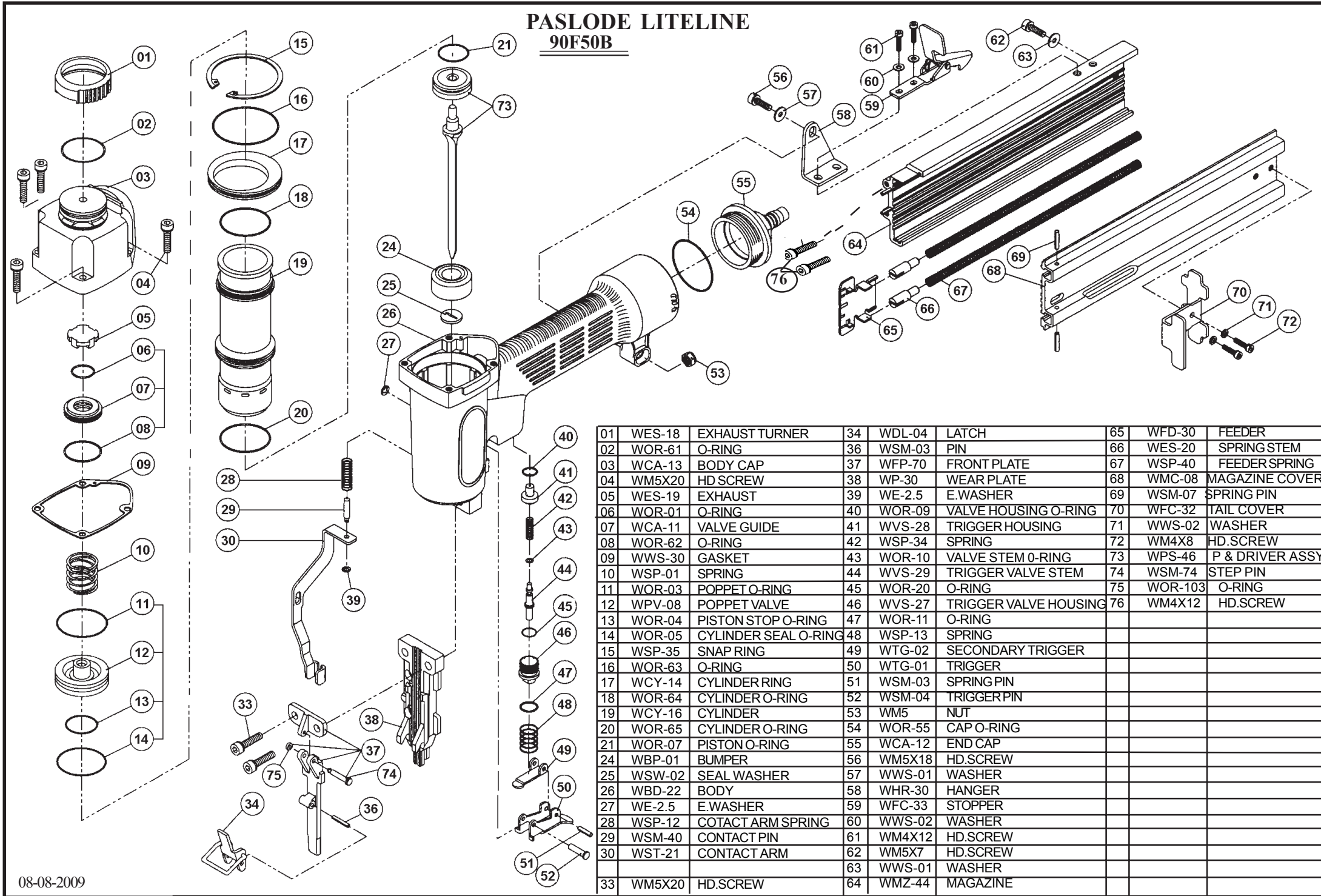

01	WES-18	EXHAUST TURNER	34	WDL-04	LATCH	65	WFD-30	FEEDER
02	WOR-61	O-RING	36	WSM-03	PIN	66	WES-20	SPRING STEM
03	WCA-13	BODY CAP	37	WFP-70	FRONT PLATE	67	WSP-40	FEEDER SPRING
04	WM5X20	HD SCREW	38	WP-30	WEAR PLATE	68	WMC-08	MAGAZINE COVER
05	WES-19	EXHAUST	39	WE-2.5	E.WASHER	69	WSM-07	SPRING PIN
06	WOR-01	O-RING	40	WOR-09	VALVE HOUSING O-RING	70	WFC-32	TAIL COVER
07	WCA-11	VALVE GUIDE	41	WVS-28	TRIGGER HOUSING	71	WWS-02	WASHER
08	WOR-62	O-RING	42	WSP-34	SPRING	72	WM4X8	HD.SCREW
09	WWS-30	GASKET	43	WOR-10	VALVE STEM O-RING	73	WPS-46	P & DRIVER ASSY
10	WSP-01	SPRING	44	WVS-29	TRIGGER VALVE STEM	74	WSM-74	STEP PIN
11	WOR-03	POPPET O-RING	45	WOR-20	O-RING	75	WOR-103	O-RING
12	WPV-08	POPPET VALVE	46	WVS-27	TRIGGER VALVE HOUSING	76	WM4X12	HD.SCREW
13	WOR-04	PISTON STOP O-RING	47	WOR-11	O-RING			
14	WOR-05	CYLINDER SEAL O-RING	48	WSP-13	SPRING			
15	WSP-35	SNAP RING	49	WTG-02	SECONDARY TRIGGER			
16	WOR-63	O-RING	50	WTG-01	TRIGGER			
17	WCY-14	CYLINDER RING	51	WSM-03	SPRING PIN			
18	WOR-64	CYLINDER O-RING	52	WSM-04	TRIGGER PIN			
19	WCY-16	CYLINDER	53	WM5	NUT			
20	WOR-65	CYLINDER O-RING	54	WOR-55	CAPO-RING			
21	WOR-07	PISTON O-RING	55	WCA-12	END CAP			
24	WBP-01	BUMPER	56	WM5X18	HD.SCREW			
25	WSW-02	SEAL WASHER	57	WWS-01	WASHER			
26	WBD-22	BODY	58	WHR-30	HANGER			
27	WE-2.5	E.WASHER	59	WFC-33	STOPPER			
28	WSP-12	COTACT ARM SPRING	60	WWS-02	WASHER			
29	WSM-40	CONTACT PIN	61	WM4X12	HD.SCREW			
30	WST-21	CONTACT ARM	62	WM5X7	HD.SCREW			
			63	WWS-01	WASHER			
			64	WMZ-44	MAGAZINE			
33	WM5X20	HD.SCREW						